

## **Dulnain Bridge**

### **Proposals**

DB/H1: The 1.51Ha field to the west of the play area would be suitable for the development of around 30 dwellings.

DB/H2: Adjacent to the A938, this site has extant planning permission for 10 dwellings. Any future proposals for the site should protect the marshland area within the site.

DB/EDI: The existing commercial business operating on the site provides an important contribution to the local economic position, and should be supported and retained.

DB/Env: A number of open spaces within Dulnain Bridge are identified as contributing to the setting of the village and will be protected from development.

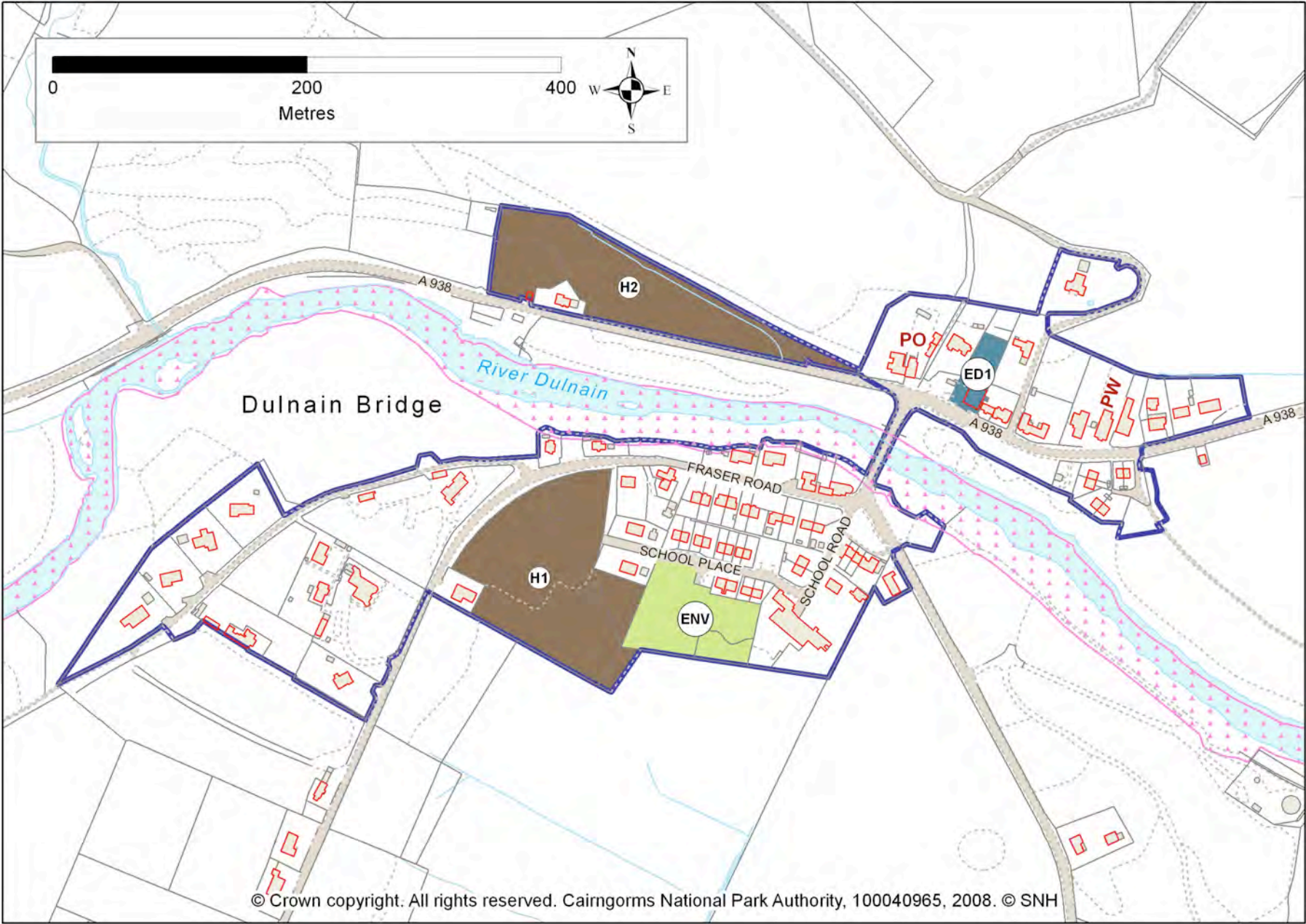

© Crown copyright. All rights reserved. Cairngorms National Park Authority, 100040965, 2008. © SNH

## Legend

-  Cairngorms National Park
-  Sites of Special Scientific Interest
-  Special Protection Areas
-  Special Area of Conservation
-  Ramsar Convention Site
-  National Nature Reserve
-  Gardens & Designed Landscapes
-  National Scenic Area
-  Conservation Area
-  Settlement Boundary
-  Indicative Settlement Boundary

## Settlement Zone Type

-  Community
-  Economic Development
-  Housing
-  Environment
-  Village Centre